



**STEELBUILD**  
INFRA PROJECTS

WHERE COMMITMENT IS  
**QUALITY**



# ABOUT US

SteelBuild Infra Projects is growing rapidly in the fast-paced industry of designing & manufacturing of modern Pre-Engineered Steel Buildings. Steelbuild is gaining immense popularity as fastest and most durable system of construction in northern part of India, by offering a complete and comprehensive solutions that covers entire cycle of production and delivery right from project briefing to final on-site installation. Mr. Varun Arora & Mr. Sandeep Mendiratta are the prominent founders of this organization and having a rich experience of this industry to satisfy the needs of steel building in the today's construction era. After working immensely of 15 years in this industry, they stepped towards leadership to contribute quality & commitment. Through this organization, they are empowering the manufacturing techniques and product services at several locations in India. Moreover, Steelbuild Infra Projects offers progressive technology with custom designs that suit to client's business requirements. Steelbuild Infra Projects is providing the finest building products according to customer requirement and creating milestone by delivering the projects. The entire organization is based on work on the belief of transparency where sustainable & innovative solutions are being provided. Their network has reached widely in India as a leading brand in the sectors of Industrial, Commercial & Residential and have earned trust by delivering the quality-products, innovative & advanced solutions for every business need.

## VISION

Our vision is to be the most admired & trusted organization that offers excellence in all aspects of steel structure products and services.

## MISSION

Our mission is to work with supremacy to stand out from the crowd by satisfying the customer's requirements by providing quality services.

## VALUES

- Trustworthy & Solidarity
- Empowering the Innovation
- Customer Satisfaction

## STEELBUILD INFRA

- Pan India Access
- Financial Turnover 150 Cr+
- Manufacturing capacity of 25,000 MT Per Annum with dedicated Three Units
- Dispatch Capacity Per Month 2000 MT+
- World Class Manufacturing Capabilities
- An ISO 9001:2015 Certified Company
- More than 500 Projects Deliver across Pan India





## QUALITY

A company only becomes a brand if it serves with honesty & reliability in the terms of Quality. We don't speak because we do it with our actions. To provide products of High-quality, we have a team of highly-experienced & skilled engineers because we don't compromise with our client's expectations. Furthermore, advanced technologies are being used for our projects (Pre-Engineered Buildings). The building materials & their sources are verified & certified before manufacturing the client's demand to meet the Industry-Standards. Steelbuild Infra Projects has expertise in Pre-Engineered Buildings that is the ideal choice for Regional and National Projects.



## SUSTAINABLE DESIGN

We work with a belief in sustainability to build, develop & innovate the technology which is beneficial for the environment as well as for the company. Our sustainable design allows longevity to the products which are designed by the specialized software & custom-developed tools.



## INNOVATION

Innovation has the ability to change the present development that is what Steelbuild Infra Projects does. The best part about it that no one can stop us from being innovative. We endeavor innovative ideas to originate new techniques & designs that can satisfy the requirements of our clients in numerous ways. No matter, it's small or big but the innovation is a key factor to perform unexceptionally from others.



## OPERATIONAL EXCELLENCE

We are executing reliable strategies to attain operational excellence. To offer trustworthy & valuable products at a lower operating cost with more permanence. Before finalizing the project we ensure that our customers should get the best experience which is undoubtedly value for money. For this, our entire management, customer service & team of professionals perform to the extent of perfection. Our motive is to build trust amongst our clients by fulfilling their expectations.



WHERE COMMITMENT IS

**QUALITY**

## WHAT IS PRE ENGINEERED BUILDING ?

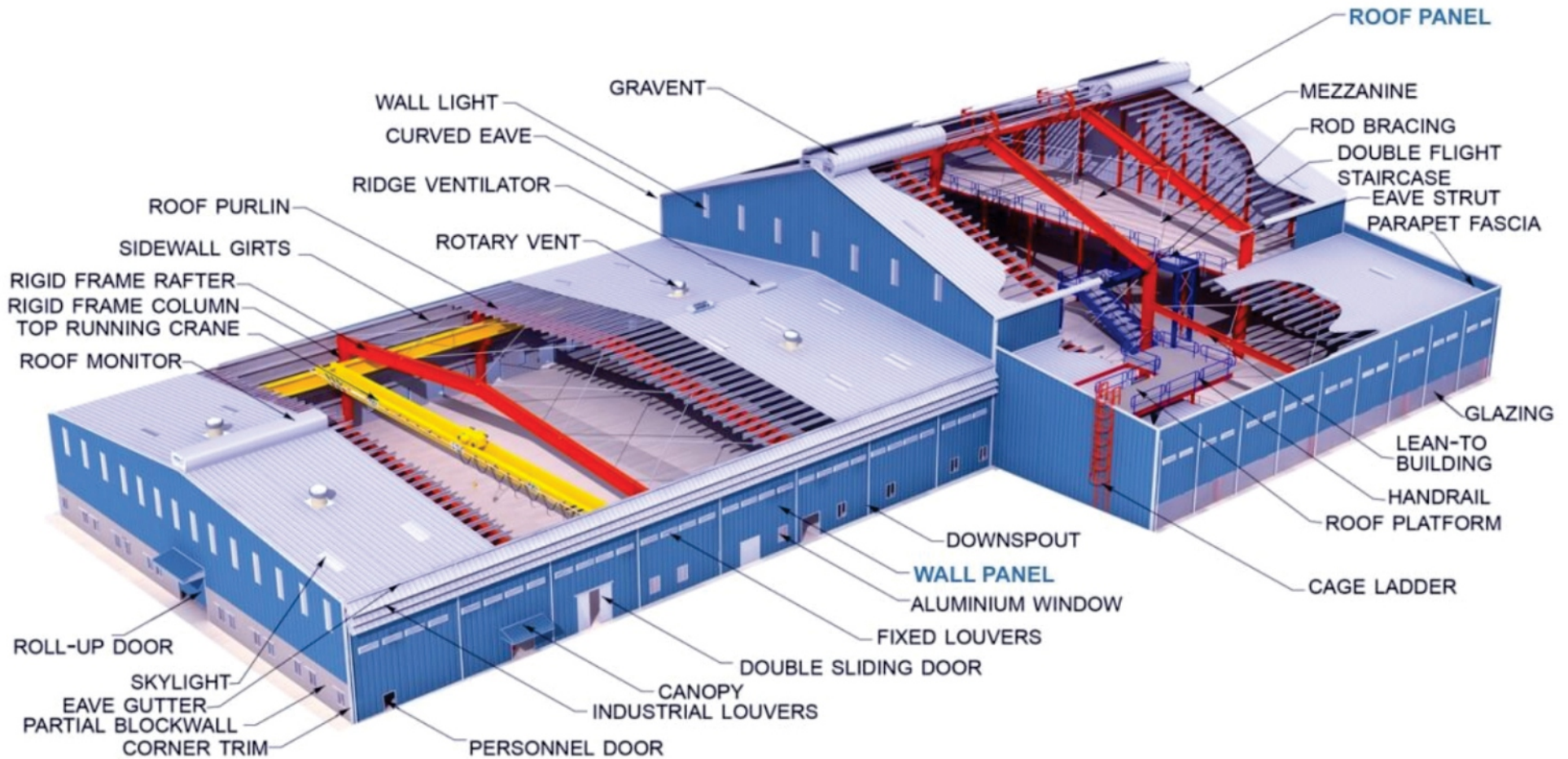

## DESIGN CENTRE

Steelbuild Buildings are designed to meet every stringent local and international code - IS (Indian standard), AISC(American Institute of Steel Construction), AISI (American Institute of Steel), MBMA (Metal Building Manufacturers Association) and AWS (American Welding Society). The Steelbuild Design Team uses world-class design and engineering software's like: STAAD pro V8i, Tekla and Auto CAD apart from customized connection and bracing design programs to deliver you best in class designs for your building.

# PRE-ENGINEERED STEEL BUILDINGS

Steelbuild Pre-Engineered Buildings can be 100% customised designed to provide maximum space utilisation, excellent strength, minimum waste and building usecase. Everything we do is keeping in mind the highest safety standard, safety is priorities at all the times.

### TYPICAL PLAN

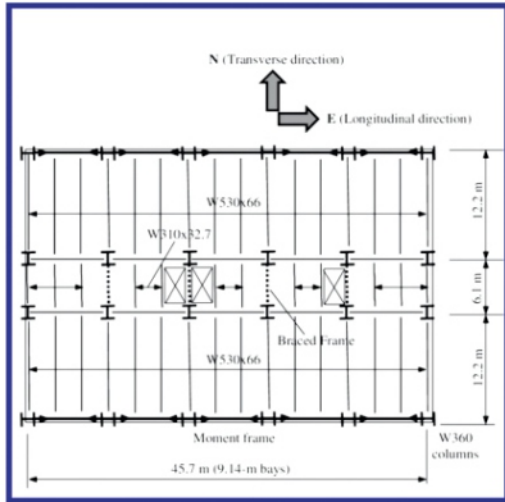

## PRIMARY FRAMING TYPE

### CLEAR SPAN

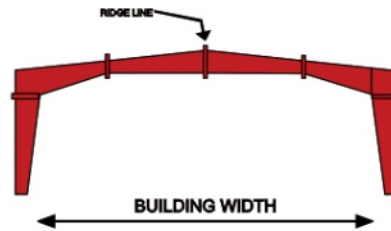

### MULTI GABLE

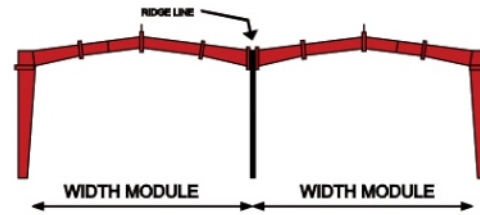

### ARCHED MULTI SPAN

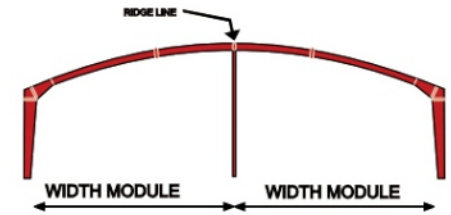

### TYPICAL SECTION

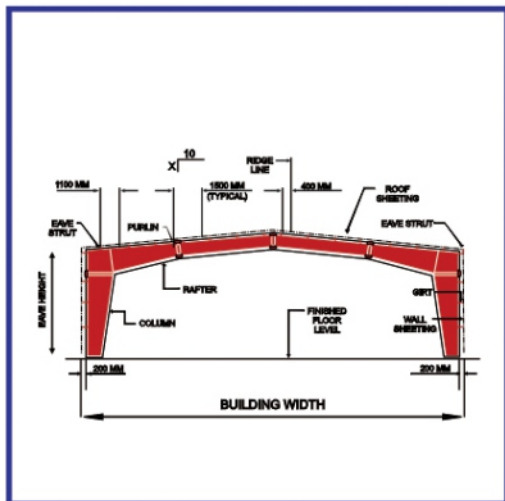

### MULTI SPAN '1, (MS-1)

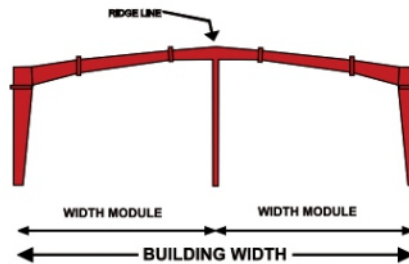

### MULTI SPAN '1, (MS-2)

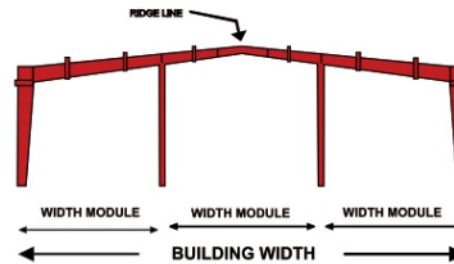

### MEZZANINE

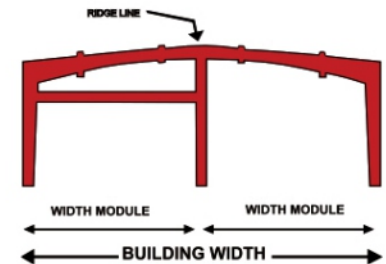



### MONO SLOPE

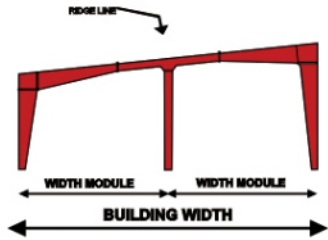

### CRANE BUILDING

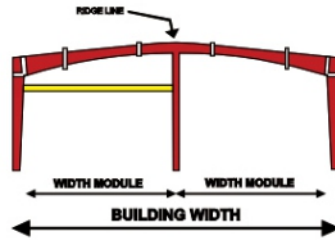

### ROOF SYSTEM

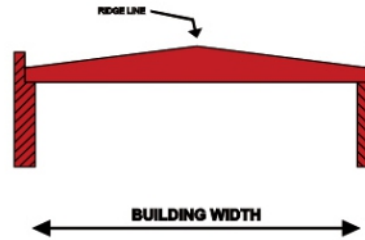

### BUTTERFLY CANOPY (T-CAN)

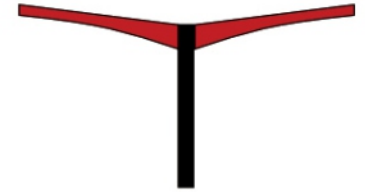

### MULTI SPAN3

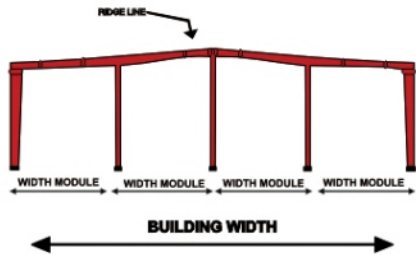

### LEAN-TO

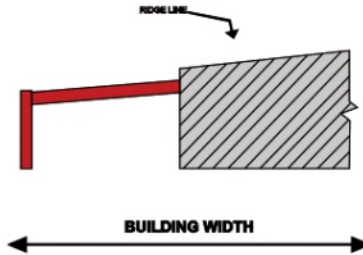

### CURVED RAFTER

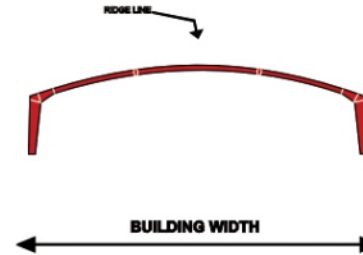

### L- CANOPY (L-CAN)

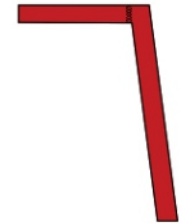

## SECONDARY MEMBERS



### C SECTION

C-Section are normally 200mm deep with a 100 flange. These flanges are perpendicular to the web and have a 24 mm stiffening lip.

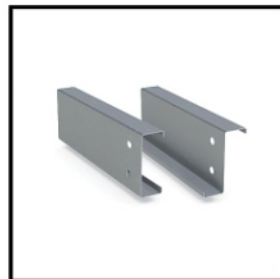

### PURLINS & GIRTS

Purlins and Girts are roll formed Z Section, 200 mm deep 64 mm flanges shall have a 16mm stiffening lip formed at 45 degree to the flange.

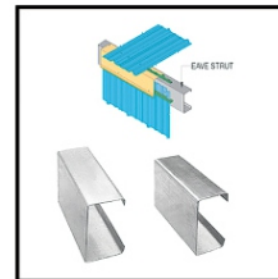

### EAVE STRUT

Eave Struts constructed from cold formed 'C' Section and it is rolled to the roof slope. This member transmit longitudinal wind force on the end walls from roof brace rods to wall brace rods.

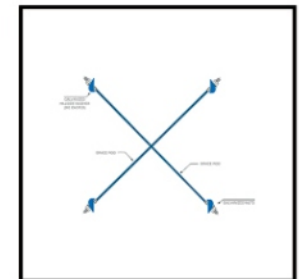

### ROD BRACING

Rod bracing (also called X- bracing) is a tension-only bracing system. Locates in the roof and walls of a building between frame members, transferring longitudinal forces to foundation. Cable bracing (like rod bracing) is a tension-only X-bracing system.

## **ROOFING & CLADDING SYSTEMS**

### **STEELBUILD ROOFING SHEET**

Steelbuild offers strong and cost effective profile and it's developed specifically for roofing applications

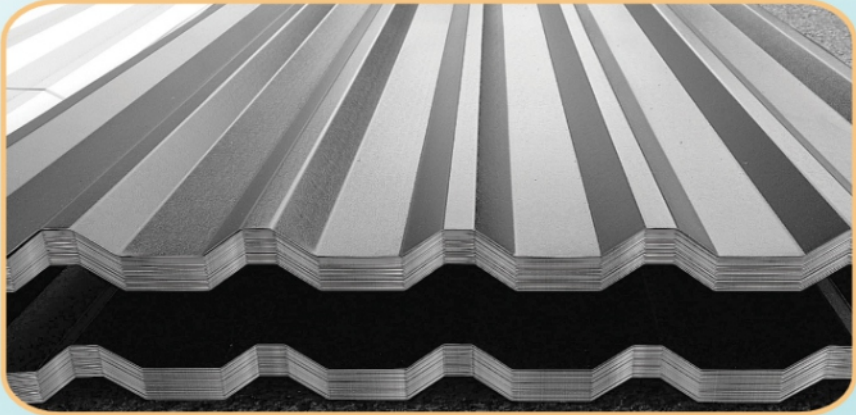

### **STANDING SEAM ROOFING SYSTEM**

Steelbuild offers standing seam systems with double lock (360 degree) standing seam, eliminates the risk of leakage at fasteners at side and end laps due to the concealed fastening systems and provide all weather projection.



### **STEELBUILD CLADDING SHEET**

Steelbuild offers strong and cost effective cladding sheet profile and it's developed specifically for concealed fastener panel with a sculptured valley shape between the major ribs for a superior architectural look for external walls.

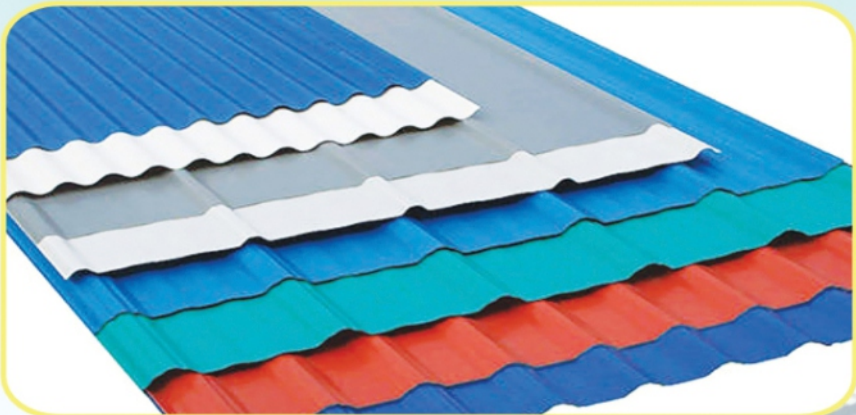

### **STEELBUILD DECK SHEET**

Steelbuild deck sheet is being used in multi-story buildings like car showrooms, warehouse, offices, industrial. These deck sheets are being used as permanent shuttering to support the concrete and helps in creating composite slabs and floor beams.

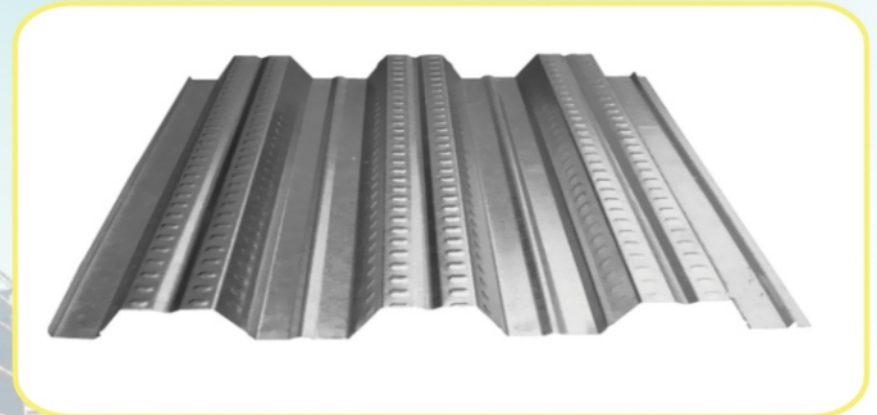

## SHEETING ACCESSORIES



### **DOWNTAKE PIPE**

Downtake pipes are used to transport the water down, directly from the roof or from the gutters, until the storage tank. The Gutters offers least resistance and result in optimum flow. Their wider mouth reduces wastage of water by splashing.



### **RIDGE CAP PIPE**

Ridge Cap, a material or covering applied over the ridge of a roof, that covers the ridge and overlaps the intersecting field roofing.



### **GUTTER**

A material or covering applied over the ridge of a roof, that covers the ridge and overlaps the intersecting field roofing.

## INSULATION

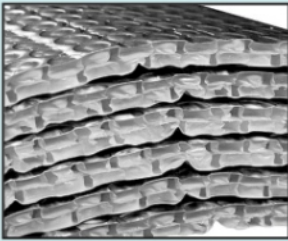

### **AIR BUBBLE**

Reflective air bubble insulation reflects heat and almost 97 percent of radiant heat rays to keep the inner atmosphere at stable temperature. Application of polyethylene bubble insulation includes similar to fiberglass application and such material can be used in both hot and cold climates.

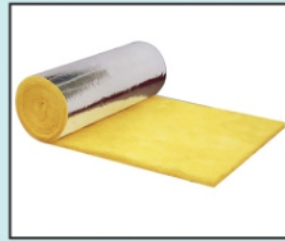

### **GLASS WOOL**

Glass Wool is an insulating material made from fibers of glass arranged using a binder into a texture similar to wool. The process traps many small pockets of air between the glass, and these small air pockets result in high thermal insulation properties.



### **ROCK WOOL**

Mineral Wool is any fibrous material formed by spinning or drawing molten mineral or rock materials such as slag and ceramics. Applications of mineral wool include thermal insulation, filtration and plays vital role in fire resistance to the building.

## ACCESSORIES



Turbovents



Ridge Ventilator



Louvers



Polycarbonate Sheet

# STEELBUILD HALL OF FAME



ON TIME, EVERY TIME!

NO DELAYS

NO COST OVERRUNS

NOW YOU CAN RELAX!



## CUSTOMIZED PRODUCTS

We also offer our clients customized products according to their business requirements. These custom products are designed & manufactured as per the demand of the customers for which we keep the industry-standards in the mind to make them aesthetic & competitive at the same time. The weather resistant & corrosion features make our products competitive in the market.



## STEELBUILD INFRA PROJECTS SUPREMACY

- Economical
- Manufacturing Quality-Control
- Translucent
- Expansion flexibility
- Environment-Friendly
- Long-term Durability
- Easy to install
- Weather Resistant roof & wall coverings



## APPLICATIONS

- Ware Houses
- Cold Storages
- Industrial Buildings
- Showrooms
- Workshops
- Supermarkets
- Shopping Malls
- Sports Stadiums
- Banquet Halls
- Factories
- Car Parking
- Auditorium
- Metro Stations
- Airport Hangers
- Community Buildings
- Colleges
- Office Buildings
- Shipyards
- Ports
- Petrol Pump



## STANDING SEAM DUAL PROFILE ROLL FORMING MACHINE

No	Specification of the material	
1	Suitable Material	PPGL 345 Mpa
2	Width of the raw material	610mm 760mm
3	Thickness	0.5-0.7mm
No	Specification of the Machine	
1	Roller Stations	About 12 Stations
2	Machine Structure	Wire-electrode cutting frame
3	Roller Material	ASTM1045 chrome plated surface
4	Cutting	Pre Cut
5	Body Type	Container Fixed
6	Seaming Machine	360 Degree

## STANDING SEAM ROLL FORMING MACHINE

### 1. Profile drawing

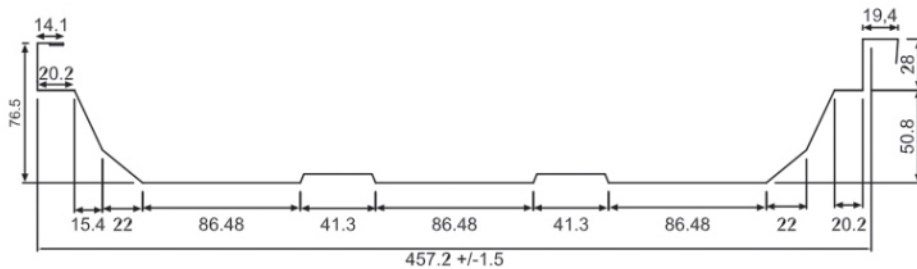

coil width: 610

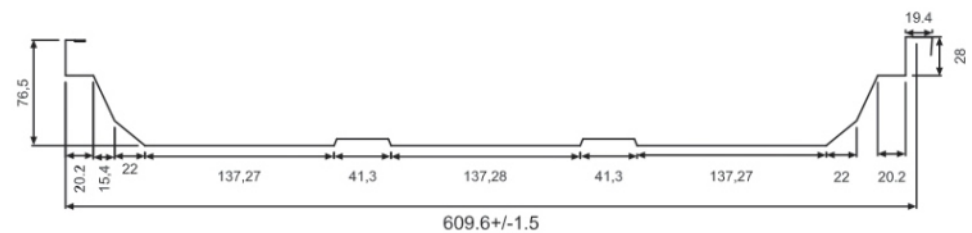

coil width: 760



**PROFILING PROCESS ON SITE**



**STANDING SEAM DUAL PROFILE ROLL FORMING MACHINE**

## MACHINERY

State-of the-art manufacturing facility with a capacity of 25,000 MT PA and ISO 9001:2015 Accredited.

### CNC MULTI-TORCH PLASMA CUTTING SYSTEM

#### Cutting and Machining flame cutting

- A pressurized mixture of oxygen and combustible gas is used in this method like propane heats the steel
- The Heat is focused on a very narrow band and the steel melts at 1500 degree celsius
- The process attains the expected cuts quickly
- Due to a rapid thermal cycle of heating and cooling residual stresses and distortion are included
- The Heat is focused on a very narrow band and the steel melts at 1500 degree celsius
- Capacity: 20MT/day
- Power max 125 Hypertherm



### HV SERIES ROLL FORMING MACHINE

- Raw material: pre-painted galvalume steel Sheet ASTMA 526/JIS G3302 SGCC or other same class of soft material
- Coil thickness: 0.3mm- 0.8mm for 550 mpa, Effective width: 1225mm.
- Line speed: max. 20m/min.
- Uncoiler Load capacity: 6MT



### QUICK INTERCHANGE C & Z PUNCHING MACHINE

- With pre leveling, pre punching & pre-cutting device
- Thickness 1.5mm-3.5mm for 345 mpa & U.S.T 550 mpa Z100-Z 350, C100-C350
- 25 m/min speed
- 5MT Automatic Decoiler
- Pre-Programmable with +2mm to corners





## HEAVY DUTY H-BEAM WELDING LINE

- Web Height 200-1500mm
- Flange Thickness 5-25mm
- Voltage 415V/50/60HZ,3Ph
- Flange Width 200-500mm
- Web Thickness 5-20mm
- Work Piece Length 2.5-13mm
- Welding wire diameter 1.6mm
- Web Taper Angle 15°
- Welding Type Single arc twin wire/single wire
- Welding Speed 300-1000mm/min (Step less speed adjustment.)

## DUTY 3 M PRESS BREAK HEAVY

- Capacity:**
- 1500 KN.
  - Max Working length-3150mm.
  - Distance between frames- 3000mm
- Sharing:**
- Sections can be cut to length or width by cropping or shearing using hydraulic shears. Heavy sections or long plates specialist plate shears.
  - For smaller plates sections-shearing knives.



We have highly skilled and motivated professional structural and civil engineers with key specialist.  
Knowledge of structural steelwork design

## Chimique India Ltd

Location- Siwani, Hisar, Haryana



## OUR PROJECTS



### PSS MODBUILD

Location - Bhalgarh, Haryana



### INDORAMA VENTURES

Location - Panipat, Haryana



### KJ PLAST

Location - Sonipat, Haryana



### D ATMOSPHERE

Location - Lucknow, Uttar Pradesh



**AKNB INFRACON**  
Location - Bhaproda, Haryana



**ADANI WILMAR LIMITED**  
Location - Ahmedabad, Gujraj



**INDUS INDIA PVT. LTD.**  
Location - Bahadurgarh, Haryana



**MULTISTOREY BUILDING**  
Location - Lalru, Punjab

## OUR PROJECTS



**MR. RAJINDER KUMAR**  
Location - Farukh Nagar, Gurgaon



**RSB CASTING LTD**  
Location - Mania, Odisha



**SEPCO ENGINEERING PVT. LTD.**  
Location - Sanand, Gujarat



**HOTEL CITY PLACE**  
Location - Nepalgunj, Nepal



### AERO COACH

Location - Tapukara, Bhiwadi



### JINDAL POLYFILMS LTD

Location - Nashik, Maharashtra



### NPT PAPERS PVT LTD

Location - Akbarpur Barota, Sonipat, Haryana



### KASTURI ASSOCIATES

Location - Raisen, Bhopal

## OUR PROJECTS



**GIRIRAJ COATED FAB PVT LTD**  
Location - Rohad, Haryana



**OM KIRAN LOGISTICS**  
Location - Hapur, Ghaziabad



**LARK ENGINEERING PVT. LTD.**  
Location - Yamuna Nagar, Haryana



**J P MINDA GROUP**  
Location - Bhiwadi, Rajasthan



**KHOLA BROTHER'S**  
Location - Tauru, Haryana



**MAHIMA ENTERPRISES**  
Location - Jamshedpur, Jharkhand



**ARVENTO PLYWOODS PVT. LTD.**  
Location - Bahadurgarh, Haryana



**SARASWATI AGRO CHEMICAL PVT. LTD.**  
Location - Derabassi, Punjab

## OUR PROJECTS

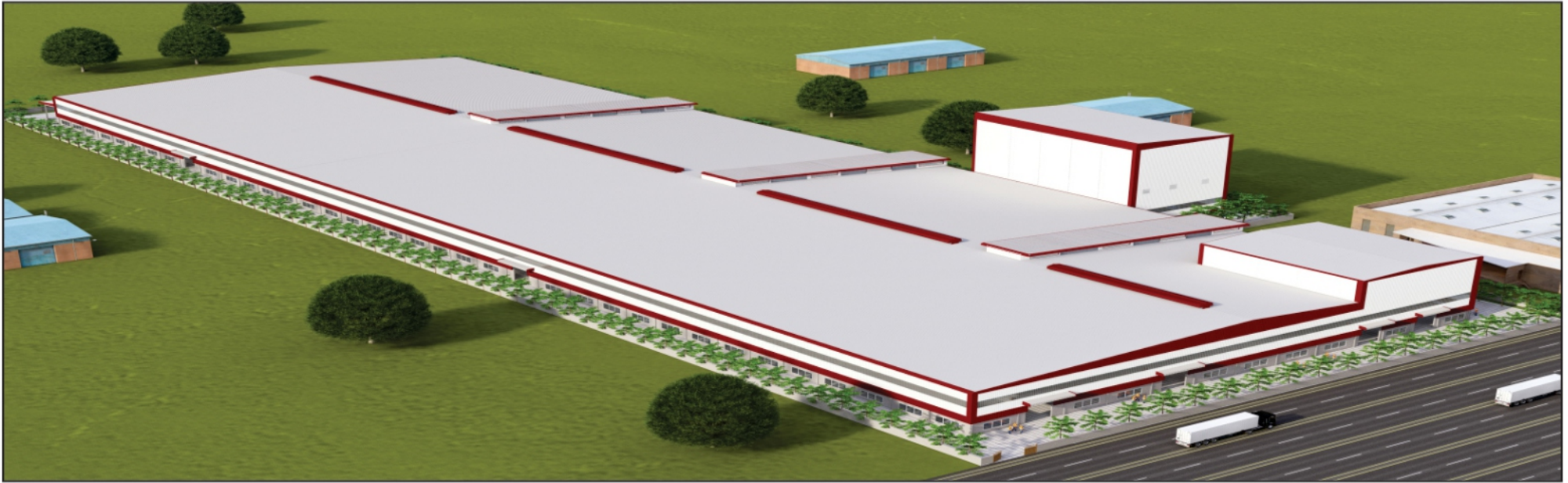

**SUDAMA WOODS PANELS PVT LTD**  
Location - Sitarganj, Uttarakhand



**SPECIAL CERAMICS**  
Location - Bhiwadi, Rajasthan



**NKG INFRASTRUCTURE LIMITED**  
Location - Karkarduma, Delhi



**AMRIT PULSES INDUSTRIES**  
Location - Kathmandu, Nepal





**GOPIRAM INDUSTRIES PVT. LTD.**  
Location - Ganaur, Sonipat



**MR. PRADEEP SINGH**  
Location - Jhundpur Sonipat, Haryana



**SAM INDIA BUILTWEEL PVT. LTD.**  
Location - Delhi



**LUCKY EXPORTS**  
Location - Tanzania

## OUR PROJECTS



### KEI INDUSTRIES LTD

Location - Silvassa, Dadar & Nagar Haveli



### ALP NISHI KAWA

Location - Lalru, Punjab



### RACHNA WAREHOUSING

Location - Dharuhera, Haryana



### DABOUR INDIA LTD

Location - Baddi, HP



**MR. AATAR SINGH YADAV**

Location - Farukh Nagar, Gurgaon



**NILE WAREHOUSING**

Location - Hassangarh, Haryana



**TRANSPORT CORPORATION OF INDIA**

Location - Greater Noida, Uttar Pradesh



**V TECH AGRO**

Location - Mohali, Punjab

## OUR PROJECTS



**TRILOKESHWAR ESTATES PVT. LTD.**  
Location - Fatua, Patna



**TUNWAL E MOTORS**  
Location - Sikar, Rajasthan



**SINGHASAN - BANQUET**  
Location - Jind, Haryana



**TUSHANK ENTERPRISES**  
Location - Jakhoda, Haryana

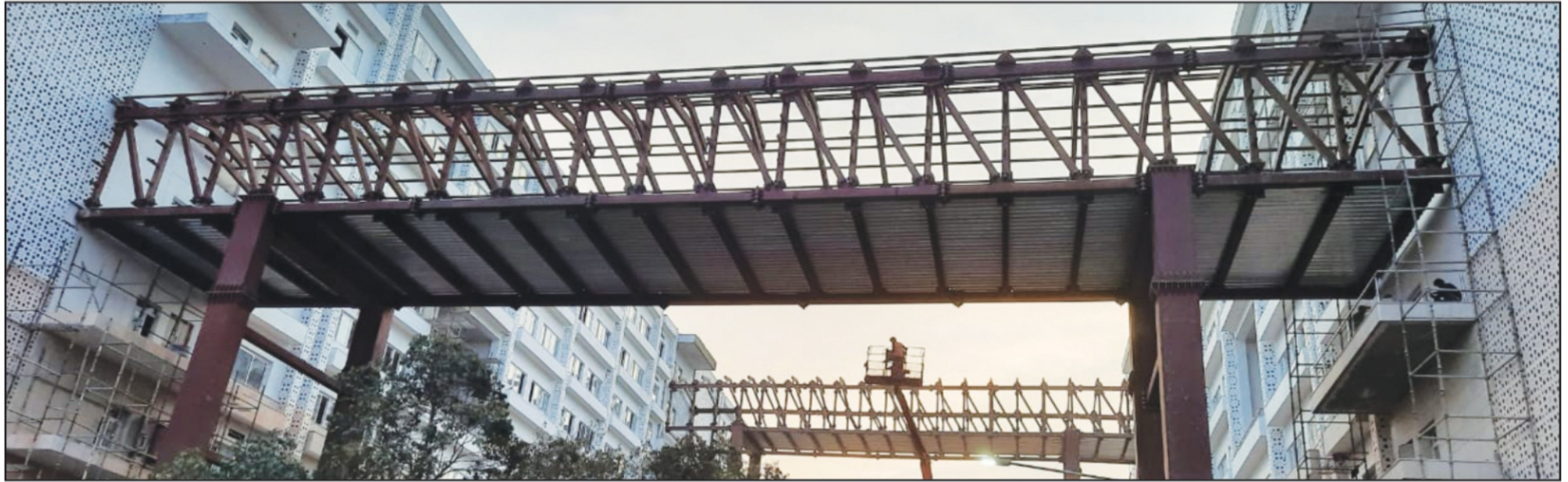

**SAM INDIA BUILTWELL PVT. LTD.**

Location - DTU, Delhi



**KABIR LOGISTICS**

Location - Bilaspur, Haryana



**ZENIYA ELECTRICALS**

Location - Bhiwadi, Rajasthan



**MR. GHANSHYAM AGGARWAL**

Location - Murthal, Sonipat

## OUR PROJECTS



**B.K. WAREHOUSING LLP**  
Location - Fatua, Patna



**VIKAS INDUSTRIES**  
Location - Sikar, Rajasthan



**VAM REALCON PVT. LTD.**  
Location - Sonipat, Haryana



**SAWHNEY PLASTICS**  
Location - Bilaspur, Haryana



### DRS STRATEGIC SPACES

Location - Lohari, Gurgaon Haryana

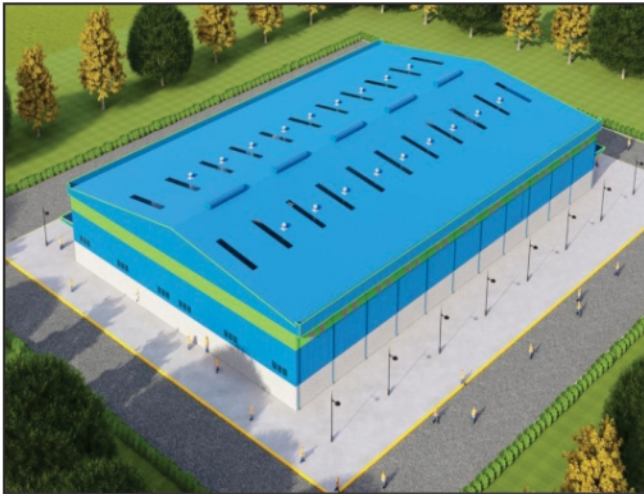

### KDM INFRA

Location - Gauripur, Assam

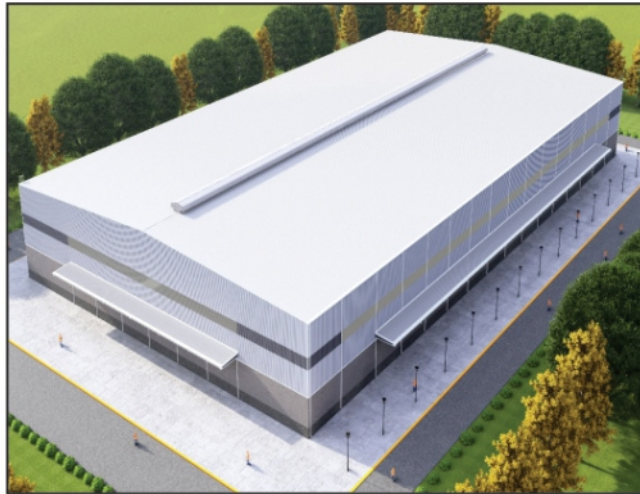

### SJS SOLUTIONS LOGISTICS

Location - Sohna, Gurgaon



### HIGHWAY WAREHOUSE AND LOGISTICS

Location - Bawal, Haryana

## OUR PROJECTS



**INDUS APPLIANCES PVT. LTD.**  
Location - Bahadurgarh, Haryana



**NEVLA GROUP**  
Location - Sonipat, Haryana



**MR. KAMAL SHINGARI**  
Location - Sonipat, Haryana



**MR. DHARAMVEER KHATTAR**  
Location - Sonipat, Haryana





**MR. TEJPAL YADAV**  
Location - Tauru, Haryana



**OM LOGISTICS LLP**  
Location - Tauru, Haryana



**NCR WAREHOUSING PVT. LTD.**  
Location - Gurgaon, Haryana



**NEELAM WAREHOUSE**  
Location - Dharuhera, Haryana

## OUR PROJECTS



**HI-TECH WAREHOUSE PVT. LTD.**  
Location - Gurgaon, Haryana



**HILSON FOOTWEAR PVT. LTD.**  
Location - Bahadurgarh, Haryana



**NMVA GLOBAL VENTURES LLP**  
Location - Manesar, Haryana



**MR. SAT NARAIN BANSA**  
Location - Bahadurgarh, Haryana

## PRESENCE OF STEELBUILD INFRA

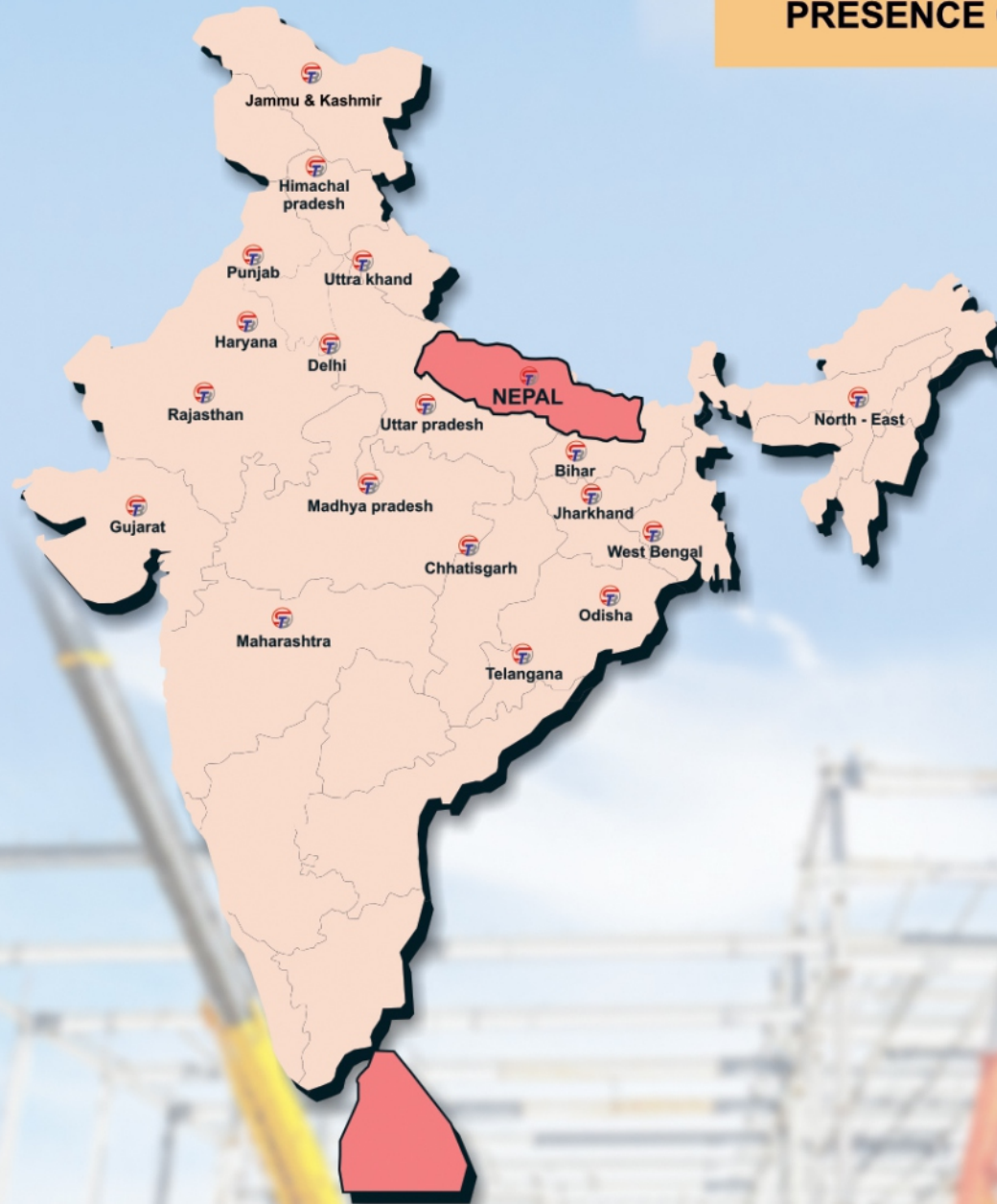



## STEELBUILD INFRA PROJECTS PVT. LTD.

Khasra No 75/21/2, 21/3, 22/2, 22/3 Village Halalpur,  
Distt. Sonapat, Haryana, 131103

**Email:** [info@steelbuildinfra.com](mailto:info@steelbuildinfra.com) **Phone:** +91 8130199427, 8295865110



Corporate  
Video